



# Portland Attendee Information Packet

November 5, 2015 – November 8, 2015

# Welcome Letter

Dear Sewtopia Portland 2015 attendee,

It is a great pleasure for us to welcome you to the Embassy Suites Portland Downtown in November.

We have a great agenda during the weekend of Sewtopia Portland. Please take a few minutes to read through the information in this packet. It includes our itinerary and other important information.

This weekend is about you leaving all the stresses of daily life behind to indulge yourself, focus on sewing projects, and get together with friends, old and new. We look forward to spending the time with you in Portland! If we can do anything to make your stay more pleasant, please let us know. Thank you for joining Sewtopia!



Sincerely,

Amy Newbold  
President | Sewtopia



Thursday, November 5, 2015

8:00AM - 9:00AM		Early Morning Check In Colonel Lindbergh Lobby area 2 <sup>nd</sup> Floor   Mezzanine Level
9:45AM - 4:00PM		Shop Hop Meet in the Main Lobby (More information Page 7 )
4:00PM - 5:00PM		Afternoon Check In Colonel Lindbergh Lobby area 2 <sup>nd</sup> Floor   Mezzanine Level
7:00PM - 8:00PM		Welcome Reception Fireside 2 <sup>nd</sup> Floor   Mezzanine Level
5:00PM - 12:00AM		Sewing Lounge Open Colonel Lindbergh Room 2 <sup>nd</sup> Floor   Mezzanine Level

Friday, November 6, 2015

6:30AM – 9:30AM		Complimentary Embassy Suites Breakfast Arcadian Garden   Lower Level Two (Two floors below Lobby Level)
8:00AM – 12:00AM		Sewing Lounge Open Colonel Lindbergh Room 2 <sup>nd</sup> Floor   Mezzanine Level
12:30PM – 1:30PM		Lunch Queen Marie Ballroom 2 <sup>nd</sup> Floor   Mezzanine Level
5:30PM – 7:30PM		Embassy Suites Complimentary Happy Hour   Bar Arcadian Garden   Lower Level Two (Two floors below Lobby Level)
7:30PM -12:00AM		Pajama Party! *Sew in PJs* Colonel Lindbergh Room 2 <sup>nd</sup> Floor   Mezzanine Level
8:00PM – 9:00 PM		Late Night Treat Colonel Lindbergh Room 2 <sup>nd</sup> Floor   Mezzanine Level

Saturday, November 7, 2015

7:00AM – 10:30AM	Complimentary Embassy Suites Breakfast Arcadian Garden   Lower Level Two (Two floors below Lobby Level)
8:00AM – 12:00AM	Sewing Lounge Open Colonel Lindbergh Room 2 <sup>nd</sup> Floor   Mezzanine Level
12:30PM – 1:30PM	Lunch Queen Marie Ballroom 2 <sup>nd</sup> Floor   Mezzanine Level
5:30PM – 7:30PM	Embassy Suites Complimentary Happy Hour   Bar Arcadian Garden   Lower Level Two (Two floors below Lobby Level)
8:00PM - 9:00PM	Michael Miller Fabric Show n' Tell & Awards Colonel Lindbergh Room 2 <sup>nd</sup> Floor   Mezzanine Level
8:00PM – 9:00 PM	Late Night Treat Colonel Lindbergh Room 2 <sup>nd</sup> Floor   Mezzanine Level

Sunday, November 8, 2015

9:00AM – Noon	Complimentary Embassy Suites Breakfast Arcadian Garden   Lower Level Two (Two floors below Lobby Level)
9:00AM – Noon	Sewing Lounge Open Colonel Lindbergh Room 2 <sup>nd</sup> Floor   Mezzanine Level



# Sewing Lounge Information & Supply List:

Sewtopia recommends you bring a very basic sewing kit for your projects. Below are the items that we suggest attendees bring:

- Thread ([Aurifil](#) will be providing one spool of thread to each attendee, this is just in case you need more)
- Pins
- Seam Ripper
- Marking pens/pencil
- Fabric Scissors
- Travel Size Ruler (*Sewtopia will have a standard 24x6 ½ rulers for general use*)
- Rotary Cutter (*Sewtopia will have a couple of 45mm rotary cutters available for general use*)
- Small Cutting Mat suggested size 12x18 (*Sewtopia will have a couple of cutting stations for general use*)

Sewtopia Sewing Lounge will have 6 to 8 ironing & cutting stations. Each station will have a large mat with a standard ruler and rotary cutter. Each ironing station will have a [Reliable](#) Sensor Velocity V200 iron and [Soak](#) Flatter Smoothing Spray.

Attendees can choose their permanent seats after check-in. The Sewing Lounge will be made up of 20 tables that seat up to 4. [Bernina staff](#) will be on hand to help you setup if you're registered for a [Bernina 350PE Machine](#). If you brought your own machine, and there's a Bernina machine at your spot, the Bernina staff will move it for you. Don't worry about packing your items up every night, Sewtopia staff will make sure the room is locked every night and reopen in the morning at 8am.

---

## Pop Up Shop

[Suppose](#) will be our Pop Up Shop during the event. They will be located near the Sewing Lounge. We're excited that this is the 2<sup>nd</sup> event that they're supporting



[Suppose](#) is Kathy Thomas & Jo Thomas, the mother and daughter team behind the destination quilt shop in Preston, Idaho. Yup, that's the home of Napoleon Dynamite, and yup, they've got a Napoleon Dynamite quilt. Suppose is all about keeping things fresh and visiting the shop is a bit of an escape. Going there is like entering another world where you can be inspired, have fun, and anything is possible. Kathy is the quilt expert, a champion antiquer, and a secret rebel—she studied drafting in high school when everyone else was taking home ec. Jo is the longarm quilter, a former therapist, and media junkie—once scoring White Stripes tickets by standing up to a mean bouncer in NYC. Suppose Quilt Boutique and Kathy & Jo's designs have been featured in Quilt Sampler and Make It Modern magazines.

# #SewtopiaSwap

We have one official swap that attendees can participate in, #sewtopiaswap. This is a blind swap, meaning we are NOT assigning partners. If you choose to participate, we ask that you bring your swap item wrapped at Check-In. If you bring an item to swap, you get one back. We will distribute swap items at the end of Friday night for you to open Saturday morning. General guidelines follows:

- If you're on Instagram please use this hashtag so others can cheer you on and your creative process
- The recommended spending limit is \$15 dollars, don't break the bank!
- Bring your swap item wrapped to Sewtopia Portland
- Make sure there's something saying who it's from like a label or a slip of paper
- Smalls category would be anything smaller than a 24x24 pillow or mini, mug rug, pin cushion, something for a sewing area, or a pouch
- Make something that you love, out of fabrics you adore.
- The folks of Sewtopia will do the secret swap Friday night after the sewing lounge closes. The swap items will be at your sewing station for Saturday morning for you to open.
- Don't worry if you don't do the swap. . . we will only hand out swap gifts to those that participated.
- Questions – email [info@gosewtopia.com](mailto:info@gosewtopia.com) and I'll collect them all in a FAQs email to everyone.



**\*Note** if you signed up for the #supersecretswap your Swap Mamas did email you with instructions. The swap is closed and partners have been assigned. If you missed it, we suggest doing the #Sewtopiaswap.

## Virtual Shop Hop

Sewtopia Salt Lake has a handful of great fabric stores for their attendees to shop virtually while their attending the event. Each shop will have their promotion code in the attendee's swag bag.

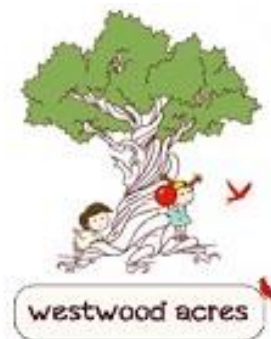

# Shop Hop Schedule

On Thursday, November 5, 2015 at 9:45AM we ask the attendees to meet in the Main Lobby of the Embassy Suites. We'll have a bus that will take you to the great fabric stores in the Portland, Oregon area. If you can't attend during this time, don't worry each shop will extend their discount if you show your attendee badge. The shops are very close to the downtown Portland area. Each shop has a special discount for the attendees and those will be announced during the shop hop.

Thursday, November 5, 2015

9:45AM – 10:00 AM		<b>Shop Hop</b> <b>Meet in Main Lobby   Embassy Suites</b> <b>Boarding Bus</b>
10:30AM – 12:00PM*		<a href="#">Modern Domestic</a> <b>1408 NW Alberta St.</b>
10:30AM – 12:00PM*		<a href="#">Bolt</a> <b>2136 NE Alberta St.</b>
12:30PM – 2:00PM		<a href="#">Fabric Depot</a> <b>700 SE 120nd Ave</b> <b>(Lunch sponsored by Fabric Depot)</b>
2:30PM – 4:00 PM*		<a href="#">Cool Cottons</a> <b>2417 SE Hawthorne Blvd.</b>
2:30PM – 4:00PM*		<a href="#">Josephine's Dry Goods</a> <b>3050 SE Division St. # 165</b>



**\*Note:** There's a couple shops that have the same time. Modern Domestic and Bolt are within walking distance of each other. Cool Cottons and Josephine's Dry Goods are close to each other but we'll be dropping half of the bus at one location and the other half at the 2<sup>nd</sup> location, after a while the bus will pick up the first half to drop them off at the 2<sup>nd</sup> location and vice versa





[Modern Domestic](#) is located in the heart of NE Portland's thriving DIY community. Started by longtime friends, Michelle Healy and Lupine Swanson, their store is a fully equipped sewing studio and retail space stocked with a finely curated selection of fabric, sewing tools, and notions. They have a warm and knowledgeable staff and a community of creative makers. [Modern Domestic](#) offers classes 7 days a week for all skill levels as well as drop-in sewing by the hour and private lessons. They provide knowledgeable sales, service, and support for all BERNINA sewing machines and sergers.

[Bolt Fabric Boutique](#) was founded in 2005 to serve their community with high quality, unique fabric and complimentary items that inspire creativity, regardless of skill level. Since then, the shop has grown to serve both Portland locals and become a popular destination for tourists. We strive to ensure that [Bolt](#) is a truly unique experience—when you walk in the door, you will discover fabrics and other delights that you haven't seen anywhere else.



Founded in 1992, Fabric Depot is a Portland, Oregon fabric & craft retail store. FabricDepot.com was launched in November 2000, and serves customers in all 50 states and over 40 countries! . They stock a vast array of brand name, first quality fabrics, notions and crafts in our retail store - over 40,000 square feet of retail space! You'll be inspired by tens of thousands of fabrics in our various departments: Quilting, Bridal, Home Decor, and Fashion. Fabric Depot also carries a great selection of quilting supplies, sewing notions, books, patterns, yarns, gifts and even specialty foods!

[cool cottons](#) is a locally owned and operated Portland Oregon fabric shop specializing in modern fabrics for quilting, sewing, crafting...and stashing! They carry high quality fabrics, some of our favorite designers and manufacturers include [Alexander Henry](#), [Art Gallery](#), [Birch Organics](#), [Cloud 9 Organics](#), [Free Spirit](#), [Michael Miller](#), [Moda](#), [Robert Kaufman](#) and [Westminster Fabrics](#). We LOVED eclectic selection of Japanese import fabrics from [Kokka](#), Cosmo, Yuwa and more. [cool cottons](#) store features a bright, cheerful atmosphere, with friendly staff members on hand to help you select the perfect fabric for your next sewing or quilting project.



The original [Josephine's Dry Goods](#) was established in 1976 quickly became a fabric odyssey. In September of 2013, Judith Head (*one of the originating founders*) closed the doors to Josephine's downtown Portland location, to retire with her grand kids. Shortly thereafter, Bini Leach and Dana Leach decided to revive [Josephine's](#). With Judith Head's blessing, expertise, guidance and assistance they re-open in the Summer of 2014. [Josephine's](#) continues to carry the highest quality apparel textiles, providing a plethora of fabric options — including, but not limited to, [Liberty of London](#) (*cotton lawns & poplins, silks, jerseys, wools & twills*), Italian wools, French laces, Japanese denim, the worlds finest linens, scrumptious silks, inspiring knits and an amazing selection of luxurious fabric blends. They also specialize in unique buttons, ribbons and trim.



[Modern Domestic](#) will be on hand near Sewtopia's Sewing Lounge as the Bernina Dealer. They will be providing three to four BERNINA sergers near their demo booth for attendee's to use. Modern Domestic will also be running great promotions on BERNINA machines. They will also be carrying a great selection of apparel items for purchase as well. Modern Domestic will also have a Q20 in their area for anyone looking to finish their quilts on a longarm machine.

They are located in the heart of NE Portland's thriving DIY community. Started by longtime friends, Michelle Healy and Lupine Swanson, their store is a fully equipped sewing studio and retail space stocked with a finely curated selection of fabric, sewing tools, and notions. They have a warm and knowledgeable staff and a community of creative makers. Modern Domestic offers classes 7 days a week for all skill levels as well as drop-in sewing by the hour and private lessons. They provide knowledgeable sales, service, and support for all BERNINA sewing machines and sergers.

**Sewtopia has a great event because of BERNINA dealers like Modern Domestic**



# Michael Miller Fabric Challenge

Sewtopia and [Michael Miller Fabrics](#) sent a great bundle of fat quarters to each of the attendees. We choose to spotlight some of [Violet Crafts](#) new fabric collection called, "[The Highlands](#)" for the challenge. Attendees can use one or all of the fabric prints, just make sure to only use Michael Miller Fabrics with your creation. At the time of check-in, we'll ask for the project and your entry form. We'll display everyone's project during the weekend. Our judges will do their best and decide on the winners by Friday night. We'll do a show n' tell of everyone's project Saturday night at 8PM and announce the winners then.

Michael Miller was born in the spring of 1999. The brainchild of Michael Steiner and Kathy Miller. Two parents brought together not by love and marriage but solely by professional respect for each other's' abilities. By leveraging their lives for an SBA loan, borrowing money from family and living on credit cards, Michael and Kathy were able to give birth to a start-up fabric company called "Michael Miller Fabrics".

michae| miller FABRICS

As time went on the company grew to a team of around 20 people and moved to a "home" of its own at 118 West 22nd street in New York City.

This dedicated and enthusiastic group are committed to expanding with a product that stands out in the industry, while at the same time closely tending to the needs of the customers we hope to inspire.

-----

michae  miller FABRICS		
<b>Entry Form</b>		
<b>Name (First, Last)</b>		
<b>Mailing Address</b>		
<b>City, State, Zip</b>		
<b>Phone Number</b>		
<b>Description of Entry</b>		
<b>Was a pattern used for this project? If so, please credit.</b>		

[Pellon®](#) brand products are distributed in the United States and Canada through the PCP Group, LLC (Pellon® Consumer Products) in Saint Petersburg, FL. They continue to be the industry leader in the interfacing category. They have interfacing for apparel, home craft & décor, quilting, fusible webs and embroidery.

[Pellon®](#) offers a wide range of batting with materials from Cotton to Wool, Bamboo to Soy, and Polyester to Rayon. Legacy™ is known as an industry leader and has quickly become the go-to batting for both beginner and advanced quilters and sewers.

For Sewtopia Portland attendees we will have a **"batting station."** The purpose of the batting station is to help you complete your projects from the classes and for any extra projects you brought along with you. **There's no extra costs!** We want you to sew, take your project to the batting station, cut what you'll need, baste, and then quilt it if needed.



## Batting Station info:

[Legacy by Pellon® Bamboo Blend Batting w/Scrim](#) a soft blend of 50% Bamboo/50% Cotton. It is needle punched onto a very lightweight sheet of scrim/polypropylene. The scrim is lighter than most in the industry today, thus making hand quilting much easier, while adding strength for hand and machine workers alike. Strength has not been compromised in any way by using this ultra-light scrim. The batting will not stretch and can be stitched up to 8"-10" apart.

[Legacy by Pellon® 100% Natural Cotton Batting](#) allows stitched areas up to 4". It has a low loft and is best used in machine work. For hand sewing use the 100% cotton with no scrim binder added. Cotton is a natural and renewable, sustainable fiber that has been used in quilts for centuries. The cotton fiber is strong, yet soft and has proven itself to last. Quilts are not destined for a landfill, yet quilters are conscious of the environment and are making choices to 'do no harm' to the earth. The growth and processing of all natural cotton does not harm the environment. It is needle punched and there are no chemicals used. Our cottons are grown and manufactured in the USA.



## Pellon Giveaway!

During the weekend at Sewtopia – Portland if you're using any of the [Pellon®](#) products snap a picture of your product and let us know what you used.

**Tag:** [@Pellonprojects](#) [@sewtopia](#) and [#pellonatsewtopia](#)

**Prize:** Pellon Prize Package TBA



[United Notions, Moda Fabrics and Moda Home](#) is a multi-line fabric, notions and finished product manufacturer and distributor selling to the trade. They offer a wide range of fabrics, notions, patterns, books, quilting supplies and finished product in their Dallas warehouse. They have been in the quilting and fabric industry since 1975 and are constantly striving to bring the latest and greatest in both their fabrics and other quilting and home products. Moda currently has independent designers as well as an in-house design staff bringing you some of the hottest new lines of fabrics and home product available in the industry.



We're excited to have handmade lanyards made from one of their new lines by [Vanessa Christenson](#). She's a mother of 4 who likes to quilt, sew, decorate, design and have fun. She is known for her simplistic design and creative use of fabric.

Each attendee will have a lanyard from her new line call [Simply Color II](#). [Simply Color](#) focused on red, yellow, and orange. [Simply Color II](#) highlights the other side of the rainbow; green, blue, and purple.

"I don't want to say this but this is my most favorite part of the rainbow. Yes, it's true it has my two most favorite colors of green and blue, and I might add that I've warmed up to eggplant in the past (so much that I love it now!), but this time to give us some diversity we added berry to the mix and well oh my gosh where have you been all my life is all I have to say." - [Vanessa Christenson](#)





# EMBASSY SUITES HOTELS®

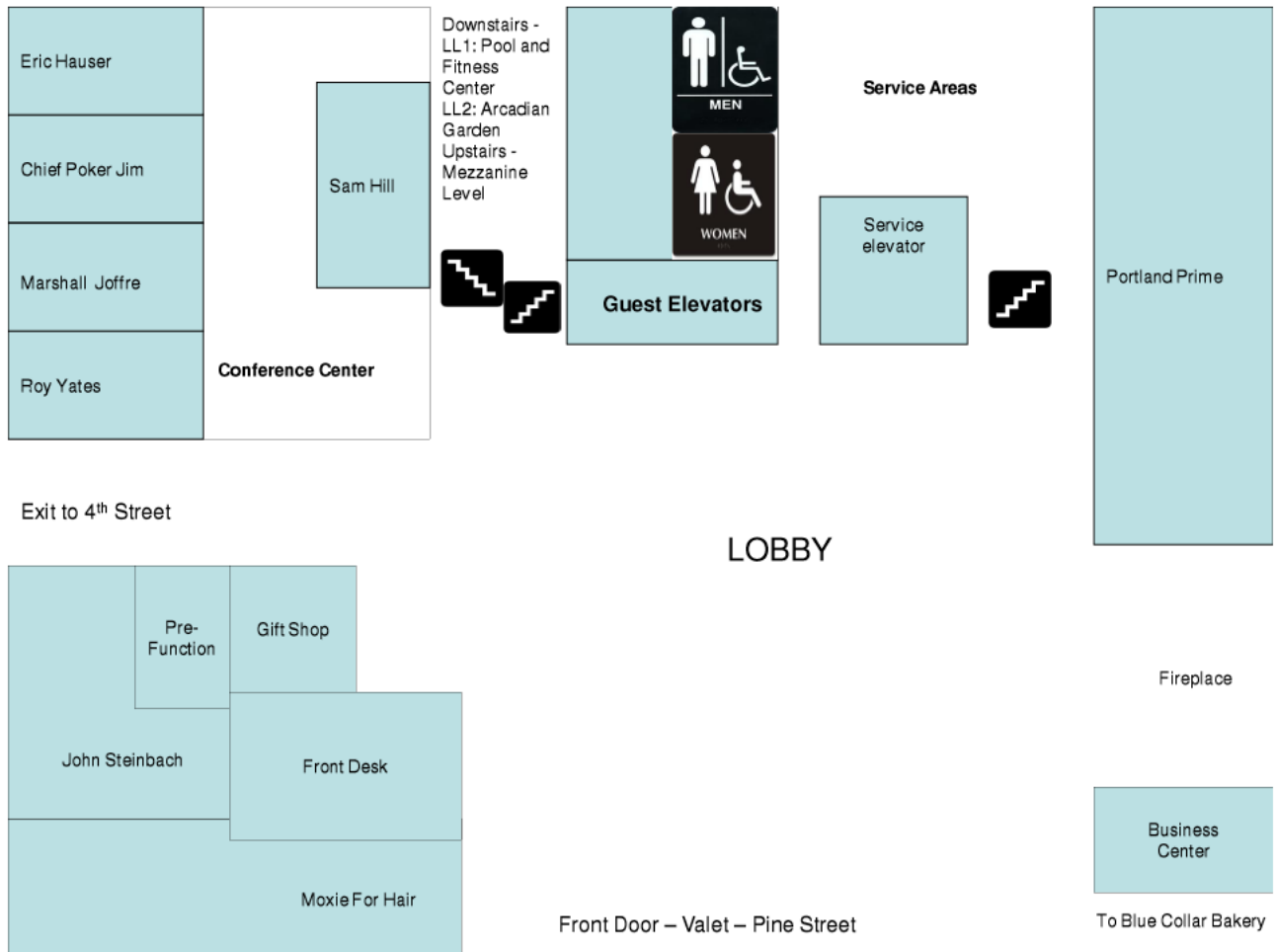

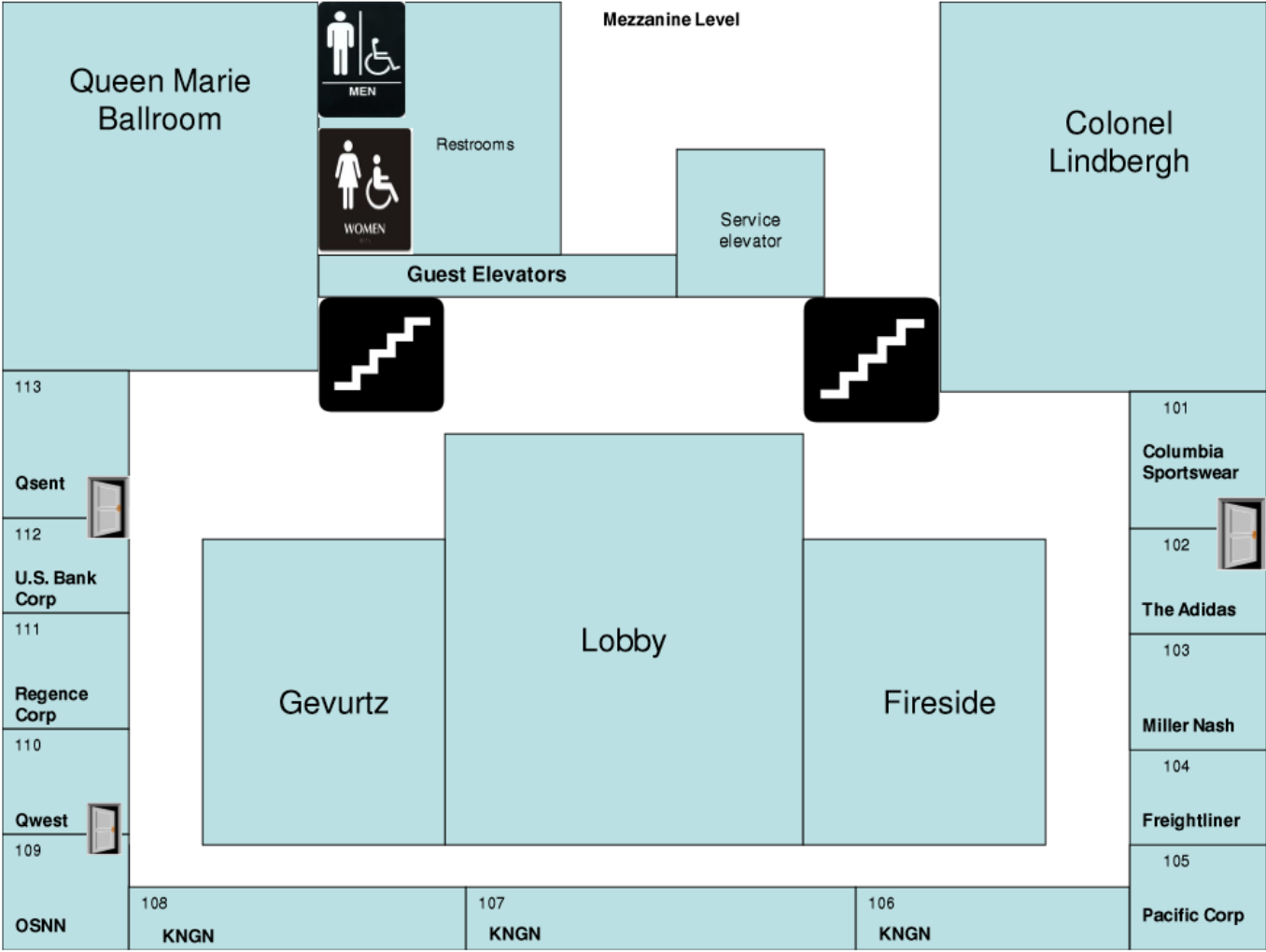



**Sewtopia Portland was  
brought to you in part  
by:**

# BERNINA

*made to create*

## michae| miller FABRICS



*moda*  
UNITED NOTIONS



neighborhood fabric boutique





# Simplicity<sup>®</sup>

## QuiltNow

ROBERT KAUFMAN  
F A B R I C S



CLOUD9  
FABRICS



***RELIABLE***

# soak<sup>®</sup>

# LECIEN



**SOCIAL  
PRINT  
STUDIO**

# THANKS FOR YOUR SUPPORT!



We'll announce our next location in  
Portland!

