



# Chicago Attendee Information Packet

April 16, 2015 - April 19, 2015

Thursday, April 16, 2015

8:00AM - 9:00AM	Early Morning Check In Walton/French Lobby area Lobby Level
9:00AM - 3:00PM	Shop Hop Main Lobby Lobby Level
4:00PM - 5:00PM	Afternoon Check In Walton/French Lobby area Lobby Level
7:00PM - 8:00PM	Welcome Reception French Room Lobby Level
8:00PM - 9:00PM	Make n' Take with Sara Lawson Walton Room Lobby Level
5:00PM - 12:00AM	Sewing Lounge Open Walton Room Lobby Level



**Friday, April 17, 2015**

9:00AM - 4:00PM		Classes with Latifah Saafir and/or Rita Hodge Sewtopia Sewing Lounge Walton Room Lobby Level
12:00PM - 1:00PM		Lunch Club International Lobby Level
4:00PM - 12:00AM		Sewing Lounge Open Walton Room

**Saturday, April 18, 2015**

9:00AM - 4:00PM		Classes with Latifah Saafir and/or Rita Hodge Sewtopia Sewing Lounge Walton Room Lobby Level
12:00PM - 1:00PM		Lunch Club International Lobby Level
4:00PM - 12:00AM		Sewing Lounge Open Walton Room

**Sunday, April 19, 2015**

9:00AM - Noon		Sewing Lounge Open Walton Room

# Quilters Quest



## Demo Schedule

	Friday	Saturday
4:00PM	Bernina Brand Ambassador, Cheryl Sleboda, demonstrates a few of the techniques from her DVD!	Tracy Mooney and her daughter, Cydney, from Generation Q Magazine will be here to demonstrate how easy it is to sew with your kids!
4:30PM	Have you ventured into the exciting world of machine embroidery yet? You won't want to miss this amazing demo!	Did you know that you can use your Bernina sewing machine to paint? Well, you can! Join us as we demonstrate the incredible Bernina Paintworks tool!
5:00PM	The only free motion quilting tool you'll ever need!! Presenting, the Bernina Stitch Regulator, or BSR for short! This handy tool will give you professional looking results without a hassle!	Circular Embroidery Attachment demo
5:30PM	Join us as nationally acclaimed teacher, Catherine Redford, demo's techniques from her bestselling DVD!	Join us as nationally acclaimed teacher, Catherine Redford, demo's techniques from her best selling DVD!
7:00PM	Join us as we demonstrate the ease of cutting simple applique shapes with the Bernina Cutwork tool!	Join us as we demonstrate the ease of cutting simple applique shapes with the Bernina Cutwork tool!
7:30PM	Circular Embroidery Attachment demo	The only free motion quilting tool you'll ever need!! Presenting, the Bernina Stitch Regulator, or BSR for short! This handy tool will give you professional looking results without a hassle!
8:00PM	The only free motion quilting tool you'll ever need!! Presenting, the Bernina Stitch Regulator, or BSR for short! This handy tool will give you professional looking results without a hassle!	Prepare to be amazed!! Machine embroidery for the masses... and it isn't even hard to do!
8:30PM	Prepare to be amazed!! Machine embroidery for the masses... and it isn't even hard to do!	The only free motion quilting tool you'll ever need!! Presenting, the Bernina Stitch Regulator, or BSR for short! This handy tool will give you professional looking results without a hassle!

## Class Information and Supply List:

Sewtopia recommends bring a very basic sewing kit for the classes. Below are the items that we suggest attendees bring:

- Thread (*Aurifil will be providing one spool of thread to each attendee, this is just in case you need more*)
- Pins
- Seam Ripper
- Marking pens/pencil
- Fabric Scissors (*each class will have a couple of scissors for general use*)
- Paper Scissors (*each class will have a couple of scissors for general use*)
- Travel Size Ruler (*each class will have a standard 24x6 ½ ruler for general use*)
- Rotary Cutter (*each class will have a couple of 45mm rotary cutters available for general use*)
- Small Cutting Mat suggested size 12x18 (*each class will have a couple of cutting stations for general use*)
- Basting Glue Spray (*each class will have a couple cans of spray baste for general use*)

**Note:** items may be relisted below to let you know you really need them

---

## Make & Take with Sara Lawson



Sara will have a small area setup for a mini make & take. She'll show you how to make a cute key fob for your keys. She'll also have patterns and fabric for sale. We're excited to have her Thursday night after the open reception.

Sara Lawson is a bag pattern designer and fabric designer from Chicago, Illinois. She has two fabric lines with Art Gallery Fabrics called 'Jungle Ave.' and 'Fantasia'. She is the author of 'Big-City Bags' and 'Windy City Bags' (the latter due out October 2015), in addition to curated collections with Aurifil threads. Her sewing pattern company is self-published under her brand, Sew Sweetness. You can find more on-line at [www.sewsweetness.com](http://www.sewsweetness.com).





## Sewtopia Class Information



The first teacher is Latifah Saafir of [The Quilt Engineer](#). She pushed the boundaries of modern quilting by “coloring outside the line.” When you look at her works, it’s not simply straight piecing. She uses curves and color that makes the projects pop.

Creativity has always been Latifah Saafir’s lifeline but, life got hectic and it got away from in her early thirties. Having sewn her whole life and with a lifetime love of quilting she stumbled upon modern quilting in 2009 and for the first time found her voice as an artist. She dove in head first. Having just finished her first quilt, Latifah co-founded the LA Modern Quilt Guild and subsequently the Modern Quilt Guild

Her engineering background lends a very methodical approach to design but, also gives her ammunition for figuring out how to put together difficult blocks. As a result you’ll find lots of challenging techniques and innovate designs in her work

Latifah Saafir will be teaching one of her new quilt patterns called Molehills. You will be learning curved piecing and a relaxed version of foundation paper piecing.

### Molehills Supply List:

- 16 half yards pieces (*this will be enough to make a baby quilt/throw*)
- Paper Scissors
- Fabric Scissors
- 28mm Rotary
- Small Ruler
- Small Cutting Mat
- Straight Pins
- Erasable Fabric Marker (air or water)
- Seam Roller (optional)



Fabric kits curated by Latifah were available to purchase from [Sew Modern](#).





The second teacher is Rita Hodge of [Red Pepper Quilts](#). She continues to amaze her readers and followers project after project. Rita's works are bright and refreshing. To what seems to be effortless work, her combination of fabric choices makes each project unique.

Quilting is her passion and fabric is her obsession. Rita's quilting style is fresh and modern using simple and often traditional design ideas to make colorful quilts.

The blog Red Pepper Quilts was started in early 2009; it is a journal of her creative self. Rita hopes to show readers that easy to make quilts can be really striking, and that by taking small risks in fabric and color selection the final product won't disappoint. It is all about sharing her knowledge. She hopes to inspire and challenge other quilters to create without fear of breaking the rules, pick up the rotary cutter and use their fabric stash, as well as learn new techniques.

Rita will be teach you how to make her Kansas Dugout Mini Quilt. This block is a traditional patchwork block but there's no triangles and only squares. She'll show how to accurately do Y-seams (*inset seams*).

## Kansas Dugout Mini Quilt Supply List:

- 3 Fat Quarters or 16 strips of fabric measuring 22" x 2.5" (*one strip for each Kansas Dugout block*)
- 16 center pieces squares measuring 2.5"x2.5"
- 9 joining squares measuring 2.5"x2.5" (*this can be the same as the center squares*)
- 1 Fat Eighth of fabric for the side and corner triangles
- Batting of your choice measuring 28"x28" (*Pellon will be providing a batting station in case you forget*)
- Backing fabric measuring 28"x28"
- Rotary Cutter
- Small Cutting Mat
- Small Ruler
- Erasable Fabric Marker (air or water) or 2B Pencil for marking fabric



Fabric kits curated by Rita was available to purchase from [Westwood Acres](#)







# The Drake

CHICAGO

WHERE THE MAGNIFICENT MILE BEGINS



LOBBY LEVEL

Ben Marshall boardroom located on the first floor  
Lakeshore boardroom located on the tenth floor

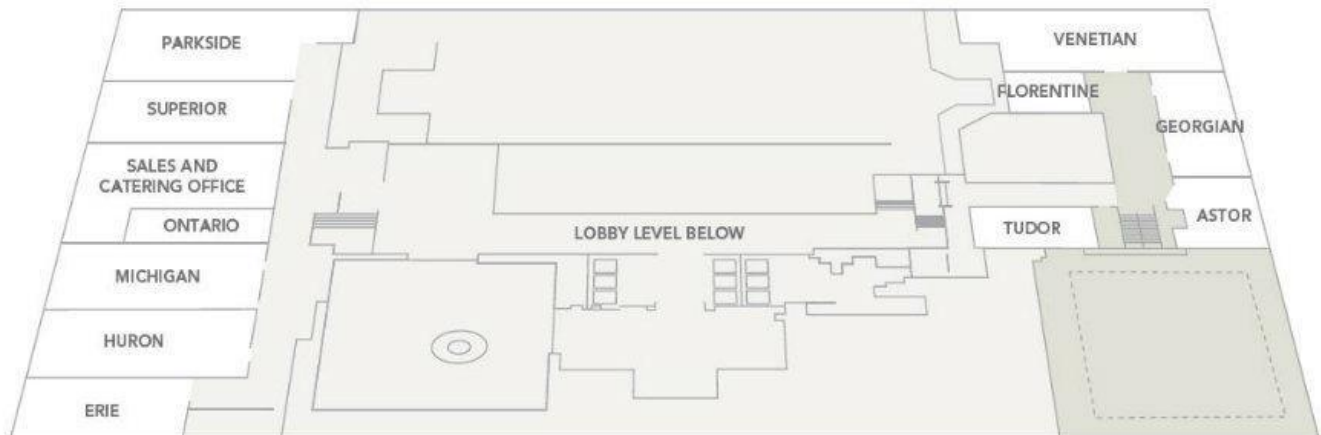

MEZZANINE LEVEL

Ben Marshall boardroom located on the first floor  
Lakeshore boardroom located on the tenth floor





**Sewtopia  
Chicago was  
brought to you  
in part by:**

# BERNINA

*made to create*



# Quilters Quest

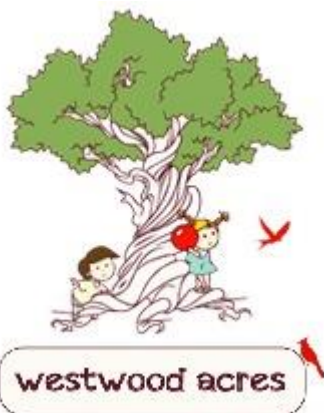

We carry EVERY color of Kona Cotton

*sew* modern



[sewmodernonline.com](http://sewmodernonline.com)



**RELIABLE**

*Free Spirit*

**GENERATION**  
*Quilt. Sew. Live. Breathe.*



**CLOUD9**  
FABRICS



**soak**

**QuiltNow**



